

# RPower OGiV25000L (2V 500Ah Battery)

Floating Life at 20°C designed for 12+ years

EAN: 4260123689681

## Dimensions

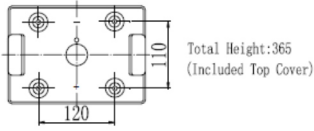
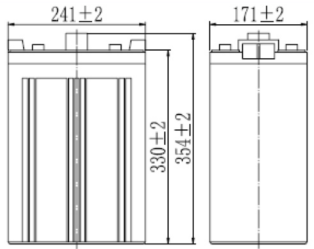

### Terminal

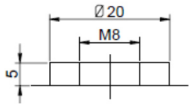

## Relationship for Open Circuit Voltage/Residual Capacity

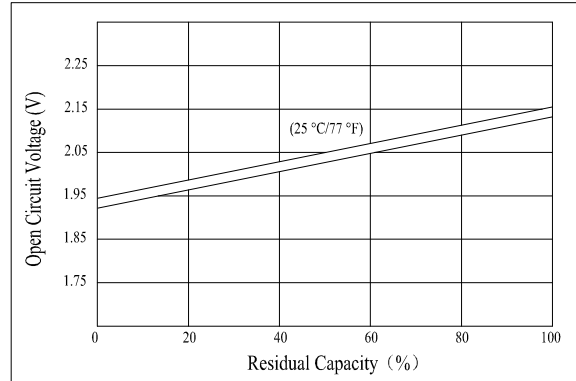

## Specifications

Nominal Voltage		2V
Capacity (10hr@25°C@1.8V/C)		500Ah
Dimensions	Length	241mm (9.49inch)
	Width	171mm (6.73inch)
	Height	330mm (12.99inch)
	Total Height	365mm (14.37inch)
Approx. Weight		30.5kg (67.3lbs)
Maximum charging current		100A
Maximum discharge current		3500A (5sec.)
Internal resistance		Approx. 0.5mΩ
Capacity affected by temperature (20hr)	40°C	103%
	25°C	100%
	0°C	86%
	-15°C	65%
Self-discharge (25°C)	3 month	Remaining Capacity: 91%
	6 month	Remaining Capacity: 82%
	12 month	Remaining Capacity: 65%
Nominal operating temperature		25°C ±3°C (77°F±5°F)
Operating temperature range		-20°C ~ 55°C (-4°F ~ 131°F)
Float charging voltage (25°C)		2.28 to 2.30V
Cyclic charging voltage (25°C)		2.40 to 2.50V
Terminal material		Copper

## Charging Characteristics

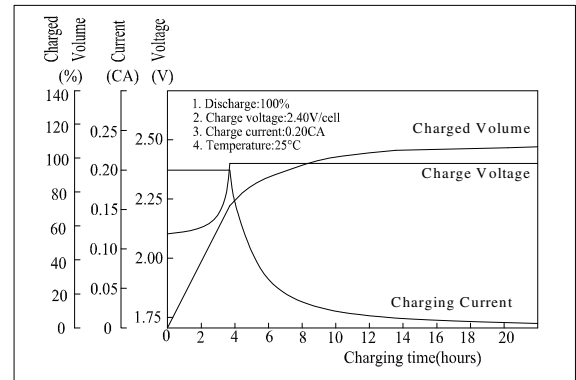

## Cycle Life in Relation to Depth of Discharge

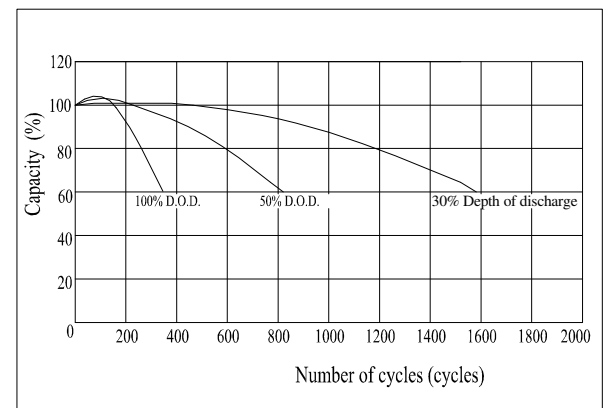

## Constant Current Discharge Characteristics (Ampere / Cell, 25°C)

F.V/TIME	30min	1h	2h	3h	4h	5h	6h	8h	10h	20h	24h
1.60V/cell	450	300	183	130	105	90,8	78,0	61,2	50,9	26,7	23,2
1.70V/cell	428	288	180	128	103	89,6	77,0	60,4	50,7	26,6	23,0
1.80V/cell	402	274	173	124	99,4	86,3	74,2	58,2	50,0	26,3	22,8

## Constant Power Discharge Characteristics (Watt / Cell, 25°C)

F.V/TIME	30min	1h	2h	3h	4h	5h	6h	8h	10h	20h	24h
1.60V/cell	842	570	353	255	205	179	154	122	101	53,4	46,6
1.70V/cell	799	547	347	252	202	177	152	120	101	53,2	46,3
1.80V/cell	751	520	334	242	195	170	146	116	99,5	52,5	45,7