

RPower OGiV24500L (2V 450Ah Battery)

Floating Life at 20°C designed for 12+ years

EAN: 4260123689674

Dimensions

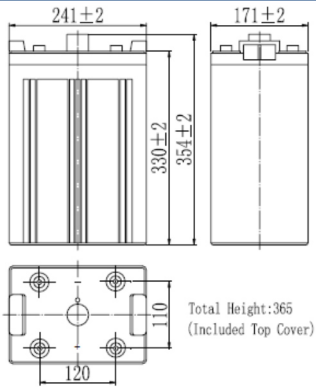

Terminal

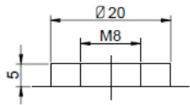

Relationship for Open Circuit Voltage/Residual Capacity

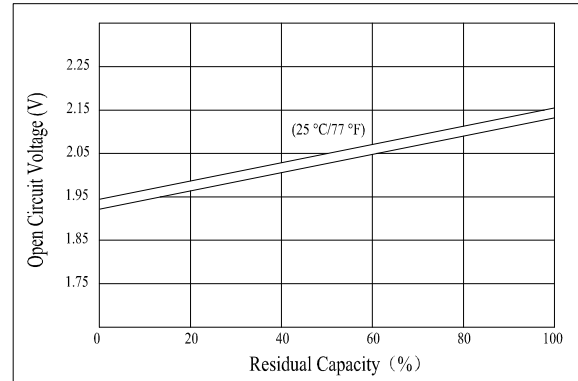

Specifications

Nominal Voltage		2V
Capacity (10hr@25°C@1.8V/C)		450Ah
Dimensions	Length	241mm (9.49inch)
	Width	171mm (6.73inch)
	Height	330mm (12.99inch)
	Total Height	365mm (14.37inch)
Approx. Weight		29.5kg (65.0lbs)
Maximum charging current		90A
Maximum discharge current		3000A (5sec.)
Internal resistance		Approx. 0.6mΩ
Capacity affected by temperature (20hr)	40°C	103%
	25°C	100%
	0°C	86%
	-15°C	65%
Self-discharge (25°C)	3 month	Remaining Capacity: 91%
	6 month	Remaining Capacity: 82%
	12 month	Remaining Capacity: 65%
Nominal operating temperature		25°C ±3°C (77°F±5°F)
Operating temperature range		-20°C ~ 55°C (-4°F ~ 131°F)
Float charging voltage (25°C)		2.28 to 2.30V
Cyclic charging voltage (25°C)		2.40 to 2.50V
Terminal material		Copper

Charging Characteristics

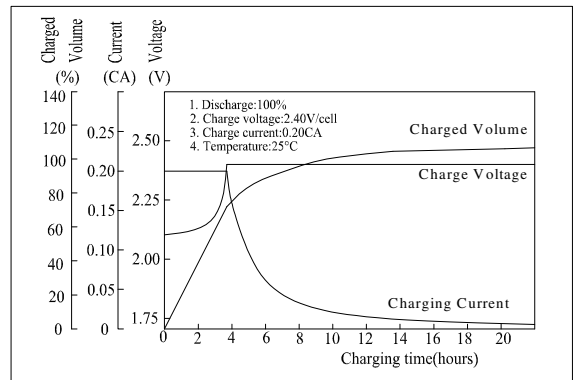

Cycle Life in Relation to Depth of Discharge

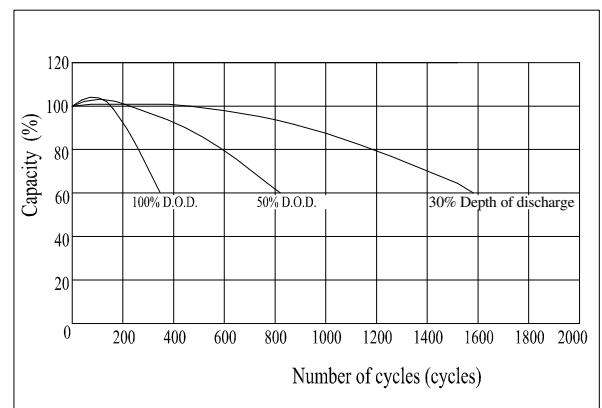

Constant Current Discharge Characteristics (Ampere / Cell, 25°C)

F.V/TIME	30min	1h	2h	3h	4h	5h	6h	8h	10h	20h	24h
1.60V/cell	405	270	164	117	94,1	81,7	70,2	55,1	45,8	24,1	20,8
1.70V/cell	385	259	162	116	92,9	80,7	69,3	54,4	45,6	23,9	20,7
1.80V/cell	362	246	156	111	89,5	77,7	66,8	52,4	45,0	23,6	20,5

Constant Power Discharge Characteristics (Watt / Cell, 25°C)

F.V/TIME	30min	1h	2h	3h	4h	5h	6h	8h	10h	20h	24h
1.60V/cell	757	513	317	229	184	161	138	110	91,2	48,1	41,9
1.70V/cell	719	492	313	226	182	159	137	108	90,7	47,9	41,7
1.80V/cell	676	468	300	218	175	153	132	104	89,6	47,3	41,2

Valid from 12-2014