

# RPower OGiV12900L (12V 90Ah Battery)

Floating Life at 20°C designed for 12+ years

EAN: 4260123683269

## Dimensions

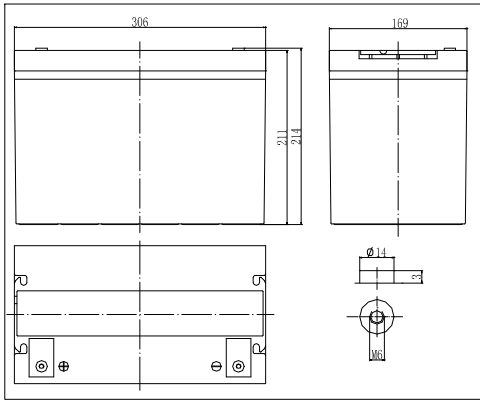

## The Relationship for Open Circuit Voltage and Residual Capacity (25°C)

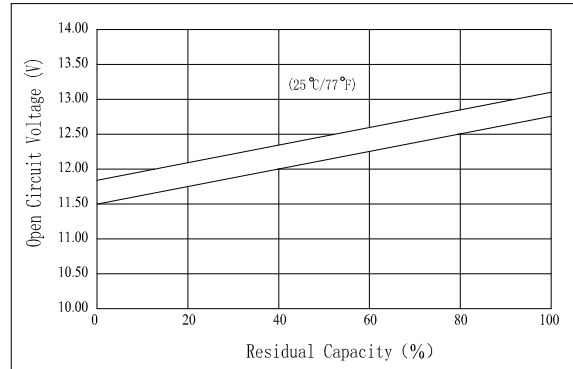

## Specifications

Nominal Voltage		12V
Capacity (20hr@25°C@1.8V/C)		94.6Ah
Dimensions	Length	306mm (12.1inch)
	Width	169mm (6.65inch)
	Height	211mm (8.31inch)
	Total Height	214mm (8.43inch)
Approx. Weight		27kg (59.5lbs)
Maximum charging current		27A
Maximum discharge current		800A (5sec.)
Internal resistance (Fully charged, 25°C)		Approx. 5.5mΩ
Capacity affected by temperature (10hr)	40°C	102%
	25°C	100%
	0°C	85%
	-15°C	65%
Self-discharge (25°C)	3 month	Remaining Capacity: 91%
	6 month	Remaining Capacity: 82%
	12 month	Remaining Capacity: 65%
Nominal operating temperature		25°C ±3°C (77°F±5°F)
Operating temperature range		-15°C ~ 50°C (5°F ~ 122°F)
Float charging voltage (25°C)		13.65 to 13.80V
Cyclic charging voltage (25°C)		14.50 to 14.90V
Terminal material		Copper

## Charging Characteristics (25°C)

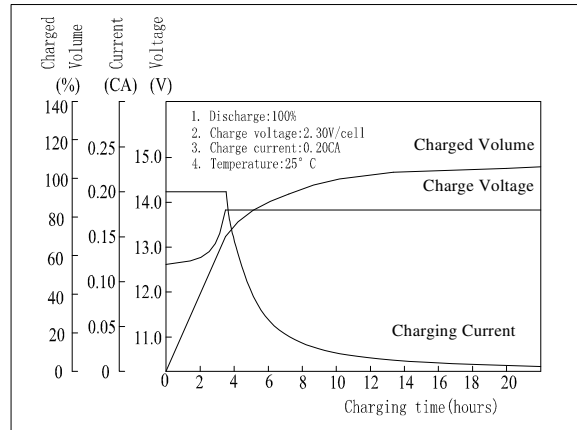

## Cycle Life (25°C)

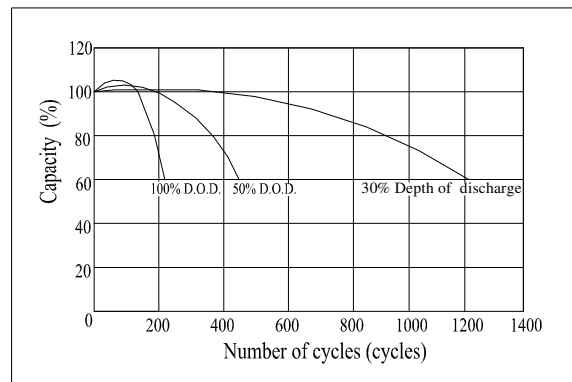

## Constant Current Discharge Characteristics (Ampere / Battery, 25°C)

F.V/TIME	5min	10min	15min	30min	1h	3h	5h	10h	20h
9.60V	284	189	149	93,6	56,7	23,3	16,4	9,14	4,80
10.2V	269	180	143	89,9	54,4	23,0	16,2	9,05	4,75
10.8V	253	169	135	85,4	51,7	22,5	15,9	9,00	4,73

## Constant Power Discharge Characteristics (Watt / Battery, 25°C)

F.V/TIME	5min	10min	15min	30min	1h	3h	5h	10h	20h
9.60V	2977	2041	1631	1050	646	274	194	109	57,6
10.2V	2828	1939	1565	1008	621	270	191	108	57,0
10.8V	2658	1823	1487	958	589	264	188	108	56,7

Valid from 12-2014