

RPower OGiV12450L

(12V 45Ah Battery)

Floating Life at 20°C designed for 12+ years

EAN: 4260123680077

Dimensions

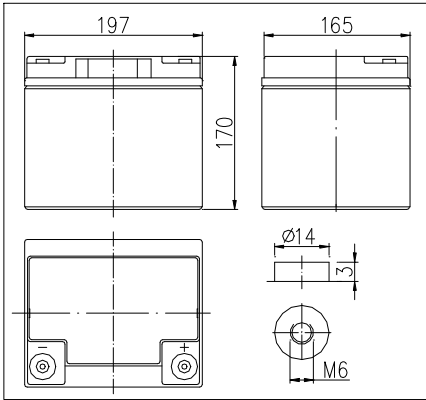

The Relationship for Open Circuit Voltage and Residual Capacity (25°C)

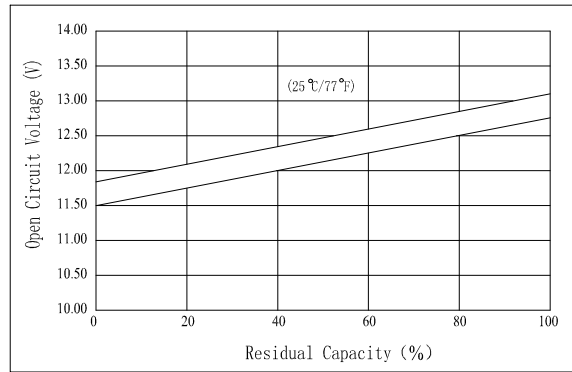

Specifications

Nominal Voltage		12V
Capacity (20hr@25°C@1.8V/C)		45Ah
Dimensions	Length	197mm (7.76inch)
	Width	165mm (6.50inch)
	Height	170mm (6.69inch)
	Total Height	170mm (6.69inch)
Approx. Weight		14kg (30.9lbs)
Maximum charging current		13.5A
Maximum discharge current		450A (5sec.)
Internal resistance (Fully charged, 25°C)		Approx. 8.0mΩ
Capacity affected by temperature (10hr)	40°C	102%
	25°C	100%
	0°C	85%
	-15°C	65%
Self-discharge (25°C)	3 month	Remaining Capacity: 91%
	6 month	Remaining Capacity: 82%
	12 month	Remaining Capacity: 65%
Nominal operating temperature		25°C ±3°C (77°F±5°F)
Operating temperature range		-15°C ~ 50°C (5°F ~ 122°F)
Float charging voltage (25°C)		13.65 to 13.80V
Cyclic charging voltage (25°C)		14.50 to 14.90V
Terminal material		Copper

Charging Characteristics (25°C)

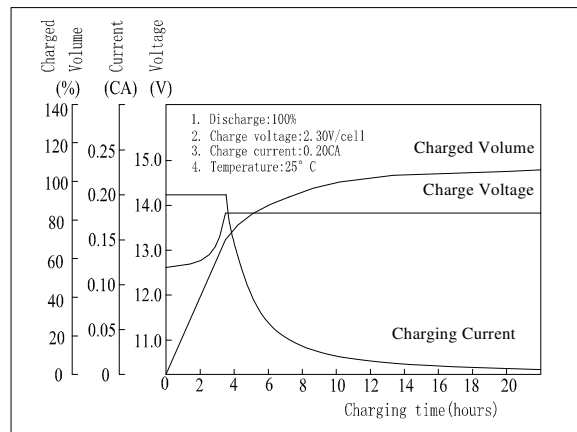

Cycle Life (25°C)

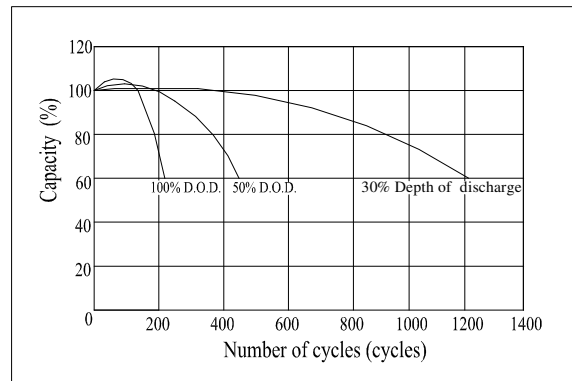

Constant Current Discharge Characteristics (Ampere / Battery, 25°C)

F.V/TIME	5min	10min	15min	30min	1h	3h	5h	10h	20h
9.60V	130	88,0	73,0	43,0	27,0	11,2	7,82	4,47	2,28
10.2V	124	83,6	70,1	41,3	25,9	11,0	7,70	4,43	2,26
10.8V	116	78,6	66,6	39,2	24,6	10,8	7,55	4,40	2,25

Constant Power Discharge Characteristics (Watt / Battery, 25°C)

F.V/TIME	5min	10min	15min	30min	1h	3h	5h	10h	20h
9.60V	1365	950	802	482	308	131	92,4	53,3	27,4
10.2V	1297	903	769	463	295	129	91,0	52,9	27,2
10.8V	1219	849	731	440	281	127	89,2	52,9	27,0

Valid from 12-2014