

PLAN

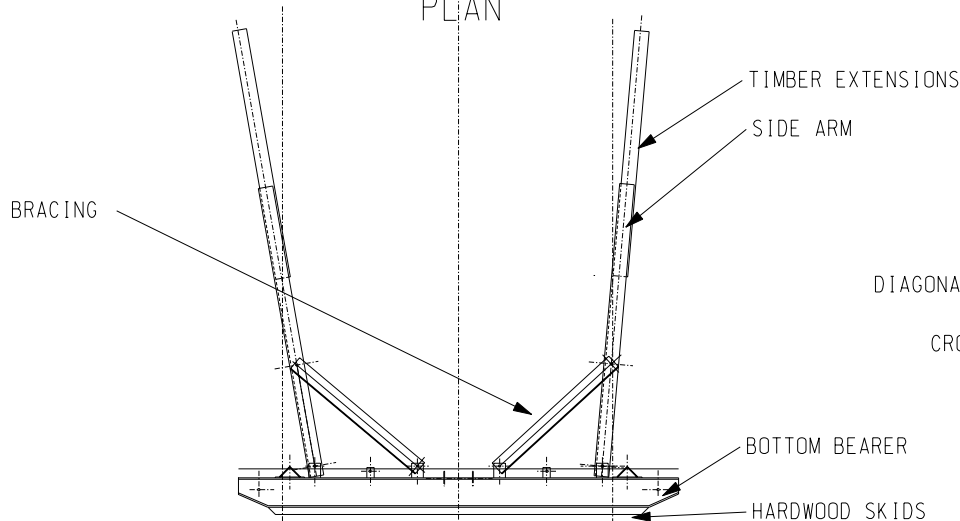

SECTION

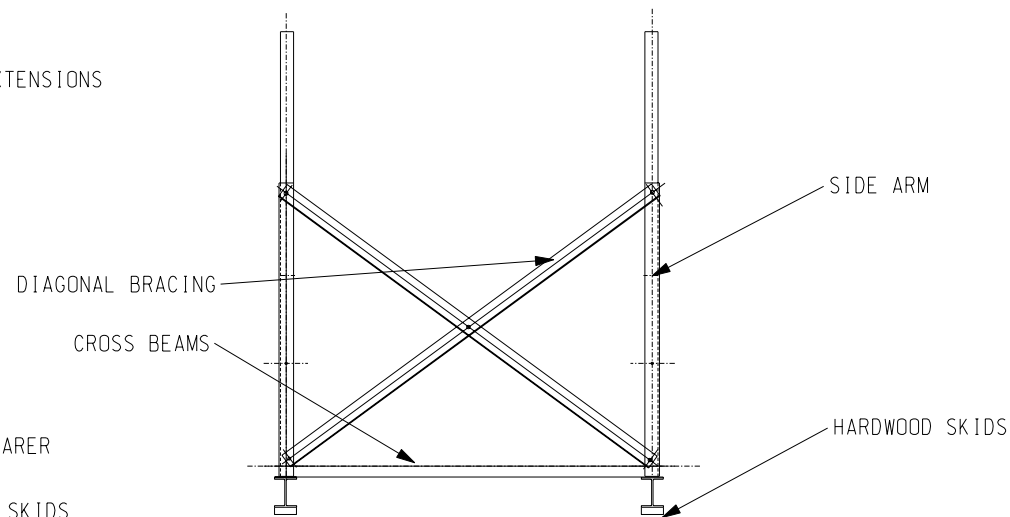

ELEVATION

NOTES:

1. ALL MAJOR COMPONENTS FOR THE CRADLE ARE TO BE OF A SIZE THAT IS COMMESURATE WITH THE SIZE OF THE BOAT.
2. ALL BRACING IS TO BE OF SIZE CAPABLE OF WITHSTANDING THE COMPRESSIVE LOADS ASSOCIATED WITH SIDE HAULAGE.
3. HARDWOOD BEARERS ARE TO AFFIXED TO THE BOTTOM OF THE BOTTOM BEARERS (MIN THICKNESS 25mm) TO ASSIST WITH SIDE HAULAGE.
4. TIMBER EXTENSIONS ARE TO BE OF SUFFICIENT LENGTH TO BE ABLE TO BE GRASPED BY HAND DURING ENTRY INTO THE CRADLE.
5. ALL FASTENINGS ARE TO BE FIT FOR PURPOSE.

THE HAULAGE MASTER OR HIS DELEGATED REPRESENTATIVE ARE THE APPROVING OFFICER FOR ALL CRADLES USED AT THE DYC DURING HAULAGE OPERATIONS. HIS DECISION SHALL BE FINAL

	3	
CENTER BEARER ORIENTATION AMENDED	2	OCT09
ORIGINAL	1	AUG09
DETAILS OF CHANGE	ISSUE	DATE

Devonport Draughting Services  
 General Draughting - Residential  
 Marine Design and Installations  
 Computer Consultancy

Telephone: 4453602 Home  
 20C Lake Rd DEVONPORT 9

3rd ANGLE PROJECTION

SCALE	NTS	CLIENT NAME	DEVONPORT YACHT CLUB
DRAWN	<i>Z</i>	CLIENT ADDRESS	KING EDWARD PDE, DEVONPORT
DATE	AUGUST 2009	TITLE	DETAILS OF A TYPICAL CRADLE FOR THE DYC HAULAGE MANUAL
APPROVED			
DRG. No.	DDS 200901	SHEET/PAGE	01
		STANDARDS	NZS 3604 BS 499

